

2.5C

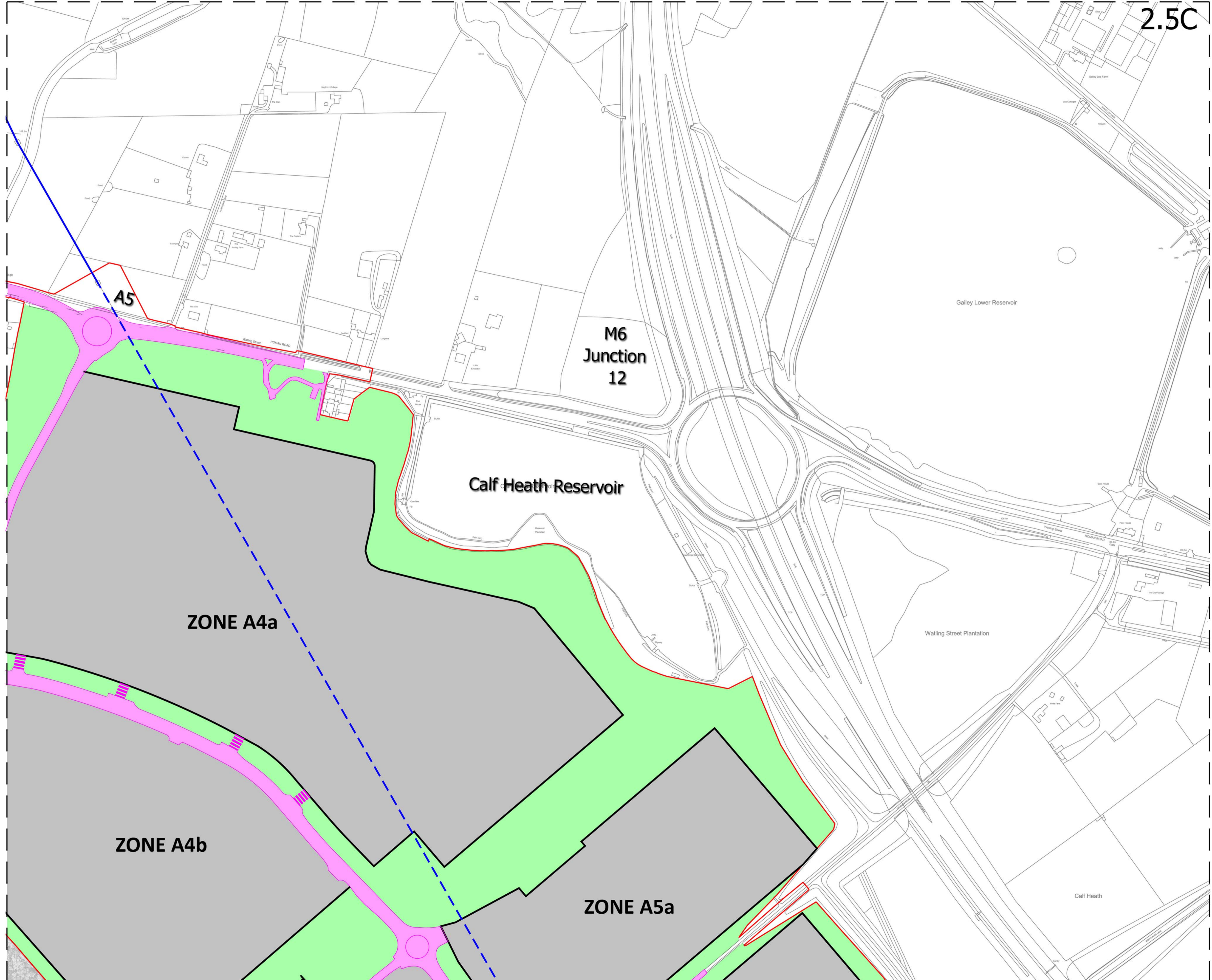
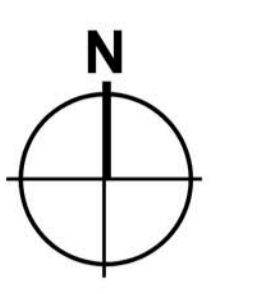

- Order Limits
- Zone A1-A7 - Development Areas
- Zone B - Rail terminal, container storage, Parking area and associated welfare facilities.
- Zone C - Rail corridor including new rail lines and landscaping.
- New on-site road infrastructure and access.
- Landscaping
- Estate Management Offices / Amenity and Welfare Facilities
- Residential Property and Curtilage
- Plot Access Points through Green Infrastructure. (precise location and extent to be approved at time of submission of details for approval post DCO approval)
- Canal crossings to be demolished
- Existing Overhead Electricity Cables
- Existing Overhead Electricity Cables to be re-routed underground

Limits of Deviation shown on works plan and set out in Article 2 of the DCO

West Midlands Interchange	
Project THE WEST MIDLANDS RAIL FREIGHT INTERCHANGE ORDER 201X	
Drawing Status SUBMISSION	
Drawing Title	Drawing Size A1
PARAMETER PLAN DEVELOPMENT ZONE PLAN - SHEET 3	
Regulation 5 (2) (o)	Document 2.5C
Drawn SM	Date MARCH 2018
Scale 1/2500	Reviewed PMS
Drawing No. 4049 - 1037	Rev. 07